

What is a Loop?

Introduction to Hearing Loops

15% of the world's adult population experience some degree of hearing loss*. A hearing loop is assistive listening technology that is used by people wearing a hearing device.

A hearing device, for example a hearing aid, amplifies all sounds. In noisy environments this can make it difficult for those living with hearing loss to distinguish the speech, music or conversation that they are trying to hear.

Hearing loops improve communication by enabling the user to hear the sound source directly by cutting out background noise.

How a hearing loop works

Speech is picked up by the microphone, converted to a magnetic signal by the amplifier and transmitted via the loop aerial. The magnetic signal is then picked up by the telecoil within the hearing aid and turned into clear speech. Clever stuff!

When signs indicate that a loop system is installed, all the user needs to do is turn their hearing device to the 'T' position and they will be able to hear with clarity.

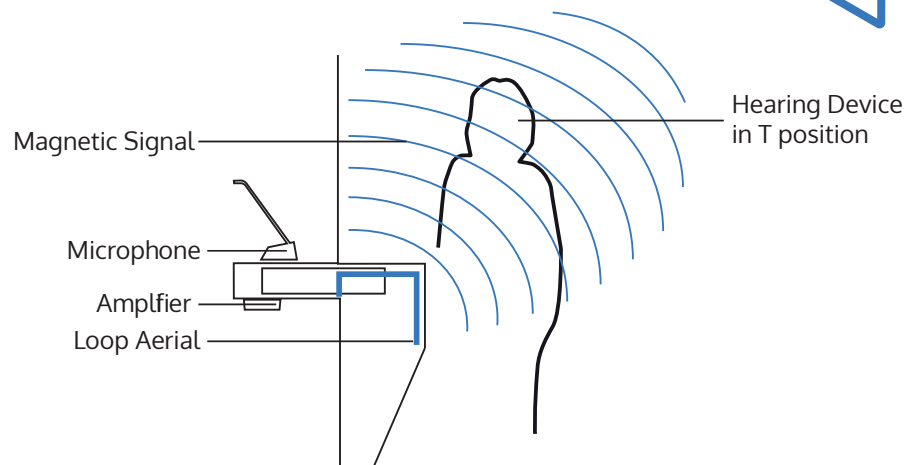
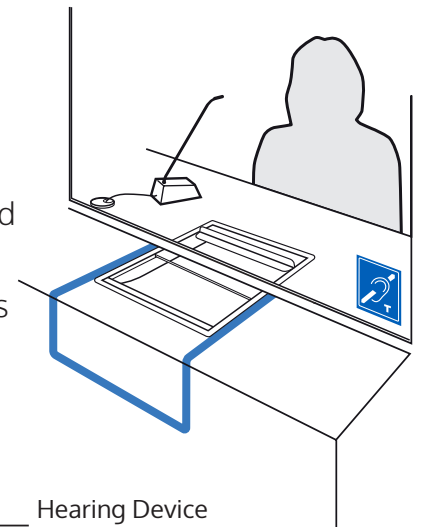

Where can hearing loops be used?

Counter hearing loops are used in many environments such as bank counters, ticket offices and supermarket check outs. They help in any situation where one to one conversation takes place.

Large area loops are installed in settings where multiple listeners can benefit from a superior listening experience such as in theatres, classrooms and conference centres.

Contacta offers a variety of powerful and discreet solutions, both fixed and portable. All of them are simple to install and easily recognisable.

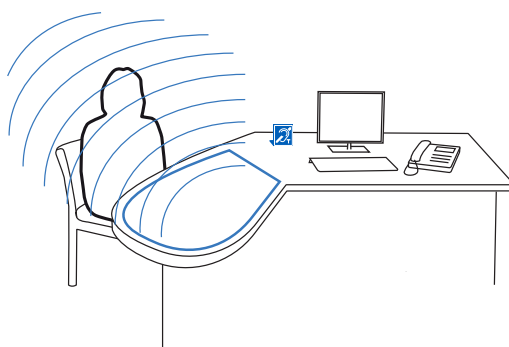

*WHO estimation for 2011.

What is a Loop?

The benefits of hearing loops

Using a hearing loop improves communication by making it easier for everybody to converse. It gives customers using hearing devices an excellent experience, encouraging them to return and building brand loyalty. The loop also makes it easier for staff to communicate, so they can provide a more efficient service.

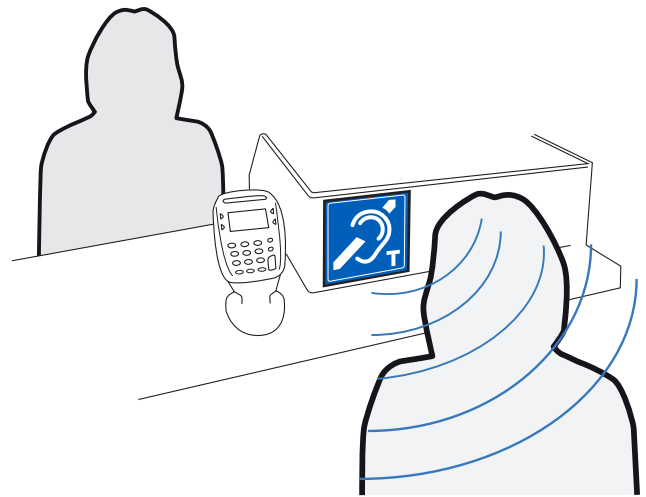

Frequently Asked Questions

Why are hearing loops necessary?

A hearing device amplifies each and every sound, which means it can be difficult for the user to hear a specific one. A hearing loop provides a direct link to the sound source, for example a television, so they can clearly hear what they are trying to hear.

Where can a hearing loop be installed?

There are multiple types of hearing loop systems so there are many possibilities. There are counter loops for one to one communication and also systems available for use in all types of rooms including large areas such as theatres or places of worship, as well as domestic loop systems for use in the home. Please contact us for more information.

Do I need a portable loop or a fixed loop?

Fixed loops are the perfect solution for a setting where one to one communication takes place regularly, giving the highest quality listening experience for the hearing aid wearer. A portable loop can be moved between rooms as required and is used in small rooms where conversation between two people takes place. It is important to make sure a portable loop is charged at all times so that it can be used when requested.

How do people know if there is a hearing loop installed?

As hearing loops are usually out of sight it is important to make people aware that a hearing loop is available. Signs should be clearly placed wherever there is a hearing loop installed.

Is a fixed counter loop always on?

Yes. Our fixed loops are always ready to use. Our unique amplifiers are extremely energy efficient, with an automatic standby mode, saving up to 80% during quiet periods.

Will the hearing loop interfere with any other equipment?

With modern technology it is rare that there is any interference. Older computer monitors, electrical wires, and transformers can cause interference or produce low pitched buzzing but with the correct configuration and installation this problem can be avoided. Talk to our experts about the ideal set up for your loop.

How can I tell if a hearing loop is working?

If you do not wear a hearing aid you will need a hearing loop listener to listen to the hearing loop. Additionally, a number of our sophisticated systems include other indicators, e.g. lights, that will show your staff that the system is fully functioning.

What maintenance is required?

It is important to regularly check that the hearing loop is working, so that the customer can always benefit from using it. We recommend a visit once a year by an engineers to make sure everything is in full working order. If you are UK based, we have our own fleet of engineers countrywide who can maintain your system, offering peace of mind that your investment is protected.



Sign for a fixed loop